



HP D5060A

HP 1024
14-inch Liquid Crystal Color Display
User's Guide

HP 1024
14-Zoll-LCD-Farbbildschirm
Benutzerhandbuch

HP 1024
Moniteur couleur à cristaux liquides
14 pouces
Guide de l'utilisateur

HP 1024
Pantalla de cristal líquido en color
de 14 pulgadas
Manual del Usuario *Léase esto primero*

HP 1024
Video a colori a cristalli liquidi
da 14 pollici
Manuale utente

Notice

The information contained in this document is subject to change without notice.

Hewlett-Packard makes no warranty of any kind with regard to this material, including, but not limited to, the implied warranties of merchantability and fitness for a particular purpose.

Hewlett-Packard shall not be liable for errors contained herein or for incidental or consequential damages in connection with the furnishing, performance, or use of this material.

Hewlett-Packard assumes no responsibility for the use or reliability of its software on equipment that is not furnished by Hewlett-Packard.

This document contains proprietary information that is protected by copyright. All rights are reserved. No part of this document may be photocopied, reproduced, or translated to another language without the prior written consent of Hewlett-Packard Company.

Hinweis

Inhaltliche Änderungen vorbehalten.

Hewlett-Packard übernimmt keine Garantie welcher Art auch immer für diese Ausrüstung, einschließlich der (doch nicht begrenzt auf die) Qualitätsgarantie und die Garantie bezüglich Eignung für einen bestimmten Zweck.

Hewlett-Packard haftet nicht für in dieser Dokumentation enthaltene Fehler oder für unbeabsichtigte oder indirekte Schäden in Verbindung mit der Lieferung, der Leistung oder der Benutzung der Ausrüstung.

Hewlett-Packard übernimmt keine Haftung für den Betrieb oder die Zuverlässigkeit seiner Software, wenn diese auf Hardware benutzt wird, die nicht von Hewlett-Packard geliefert wurde.

Dieses Dokument enthält proprietäre Informationen, die durch das Copyright geschützt sind. Alle Rechte vorbehalten. Dieses Dokument darf ohne vorherige schriftliche Genehmigung der Hewlett-Packard Company weder ganz noch teilweise fotokopiert, reproduziert oder übersetzt werden.

Avertissement

Les informations contenues dans ce document peuvent être modifiées sans préavis.

Hewlett-Packard ne donne aucune garantie de quelque sorte que ce soit concernant, sans que ce soit limitatif, les garanties implicites de qualité commerciale de ce matériel, ou la bonne adaptation de celui-ci à un usage particulier.

Hewlett-Packard n'est pas responsable des erreurs pouvant apparaître dans ce manuel et n'est pas non plus responsable des dommages directs ou indirects résultant de l'équipement, des performances et de l'utilisation de ce matériel.

Hewlett-Packard ne saurait être tenu pour responsable de l'utilisation et de la fiabilité de son logiciel sur des matériels non fournis par Hewlett-Packard.

Les informations contenues dans ce document sont originales et protégées par copyright. Tous droits réservés. L'acheteur s'interdit en conséquence de les photocopier, de les reproduire ou de les traduire dans toute autre langue, sauf accord préalable et écrit de Hewlett-Packard.

Aviso

La información contenida en este documento está sujeta a cambios sin previo aviso.

Hewlett-Packard no ofrece ningún tipo de garantía con respecto a este material, incluyendo, pero sin limitarse a, las garantías implícitas de comerciabilidad e idoneidad para un fin determinado.

Hewlett-Packard no asume responsabilidad alguna por los posibles errores contenidos o por los daños casuales o emergentes relacionados con el suministro, funcionamiento o uso de este material.

Hewlett-Packard no asume responsabilidad alguna por el uso o fiabilidad de su software en equipos que no hayan sido fabricados por Hewlett-Packard.

Este documento contiene información patentada, protegida por las leyes del copyright. Reservados todos los derechos. Ninguna parte de este documento puede ser fotocopiada, reproducida o traducida a otro idioma sin la autorización previa y por escrito de Hewlett-Packard Company.

Avviso

Le informazioni contenute in questo documento sono soggette a cambiamento senza preavviso.

Hewlett-Packard non rilascia garanzie di alcun tipo riguardo a questo materiale, comprese le garanzie implicite di commerciabilità e di idoneità per uno scopo particolare.

Hewlett-Packard non sarà ritenuta responsabile per errori contenuti in questo documento, né per danni accidentali o conseguenti alla fornitura, alle prestazioni o all'uso di questo materiale.

Hewlett-Packard non si assume alcuna responsabilità riguardo all'uso o all'affidabilità del proprio software su apparecchiature di altri produttori.

Questo documento contiene informazioni di proprietà protette da copyright. Tutti i diritti sono riservati. Nessuna parte di questo documento può essere fotocopiata, riprodotta o tradotta in un'altra lingua senza un precedente consenso scritto di Hewlett-Packard Company.

Hewlett-Packard France
Commercial Desktop Computing Division
38053 Grenoble Cedex 9
France

© 1997 Hewlett-Packard Company

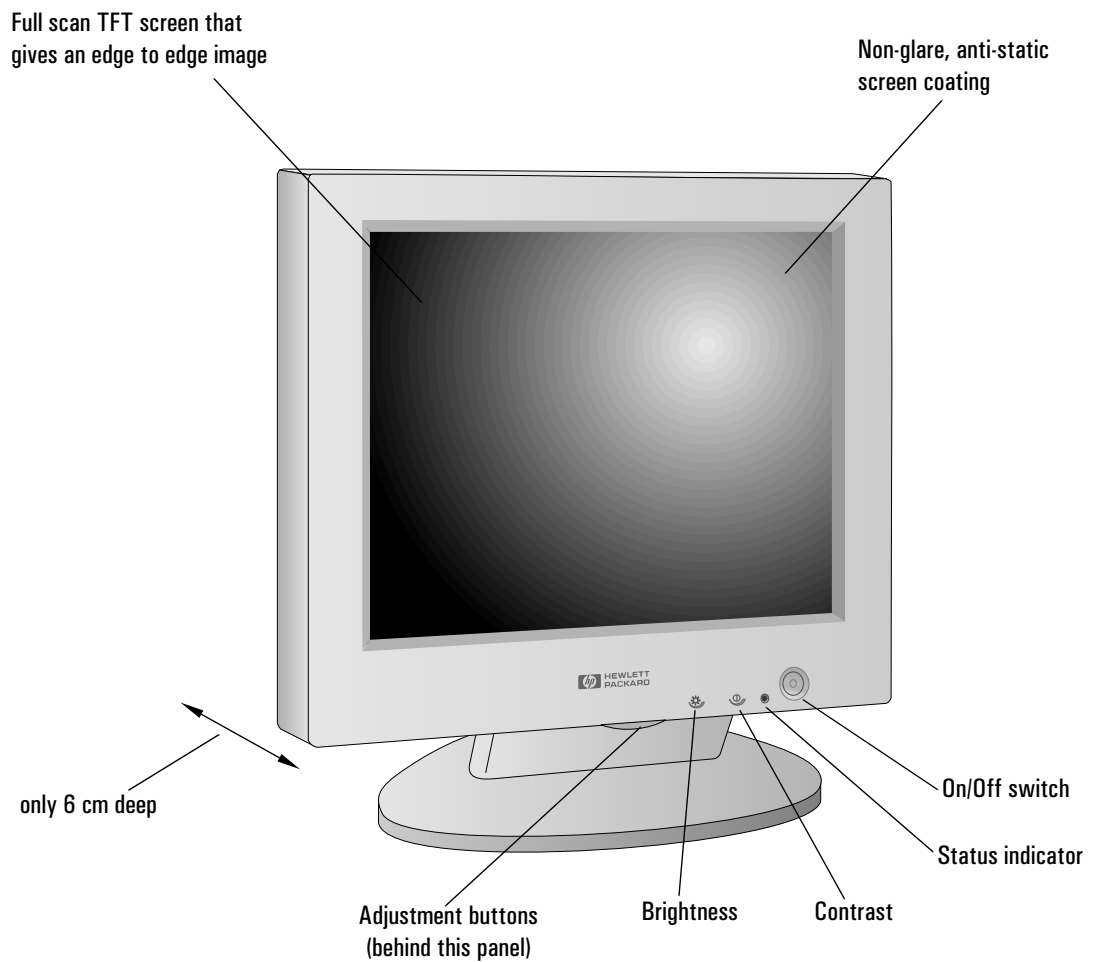

HP D5060A 1024 14-inch Liquid Crystal Color Display

User's Guide

Important Safety Instructions

Before you plug in your new display, read these important safety instructions.

WARNING

Connect the display only to a grounded power outlet. Use the power cord supplied with the display or one with a properly grounded plug. Ensure the cable meets your country's standards for safety.

To completely disconnect power at the display, remove the power cord from the power outlet. Ensure that the power outlet is easily accessible.

USA and Canada

If the power cord is not supplied with your display, select the proper power cord according to your national electric safety codes.

- USA: use a UL Listed type SVT detachable power cord.
- Canada: use a CSA certified detachable power cord.

Si le cordon secteur n'est pas livré avec votre moniteur, utiliser un cordon secteur en accord avec votre code électrique national.

- USA: utiliser un cordon secteur UL Liste de type SVT.
- Canada: utiliser un cordon secteur certifié CSA.

What Your New Display Offers

The HP D5060A 1024 Display is a 14-inch, high resolution, liquid crystal multi-synchronous color display. Multi-synchronous means that the display supports a range of video modes. It can be used with Hewlett-Packard personal computers (or equivalent). Your HP D5060A display has the following features:

- A 14-inch Thin Film Transistor (TFT) liquid crystal color display. It has a non-glare, antistatic screen coating.
- Support of video modes up to 1024 × 768.
- Image adjustment using onscreen menus.
- Display power management system (VESA¹ standard) controlled from suitably equipped HP Vectra PCs to automatically reduce the power consumption of the display. Complies with the Energy Star Computers Program initiated by the US EPA², and with the Swedish NUTEK³ specification for energy efficient displays.
- Display Plug and Play capability (VESA DDC1/2B standard) that enables the display to identify itself to suitably equipped HP Vectra PCs.
- Compliance with ISO 9241-3 and ZH1/618 ergonomic standards.
- Your HP D5060A display complies with MPRII guidelines for upper limits of electrical and electrostatic emissions, from the Swedish National Board for Measurement and Testing.
- Your HP D5060A display complies with the TCO-92⁴ guidelines for low frequency electrical and magnetic fields, which require an even lower level of emissions than the MPR-II recommendations.

1. VESA is the Video Electronics Standards Association
2. The US EPA is the United States Environmental Protection Agency
3. NUTEK is the Swedish National Board for Industrial and Technical Development
4. Swedish Confederation of Professional Employees

Setting Up Your Display

Unpacking the Display

When you unpack your display from the shipping carton, you should have the following items:

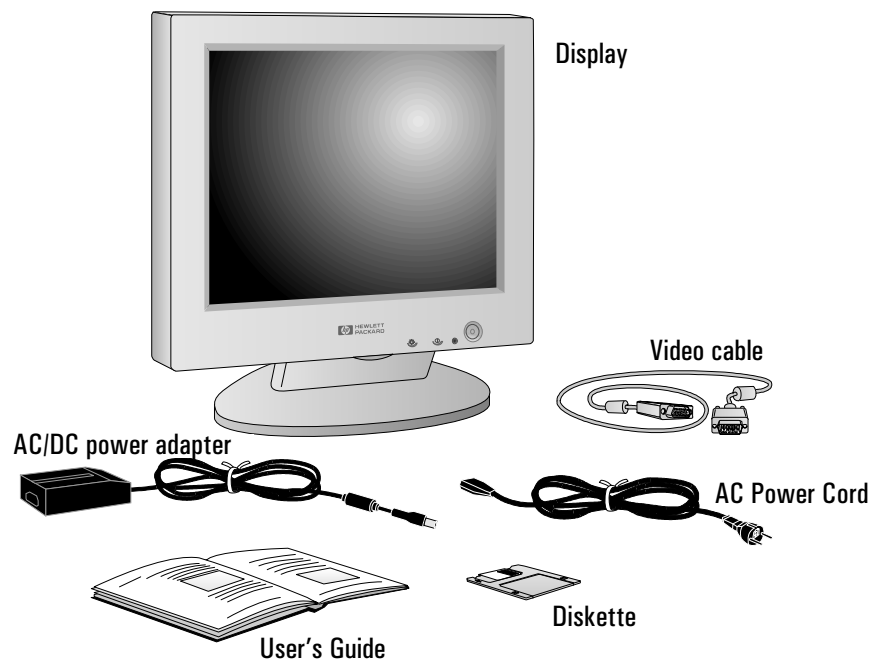

- The HP D5060A Liquid Crystal Color Display
- an AC/DC power adapter
- an AC power cord
- a Video cable
- an HP Image Optimizer diskette
- this manual.

Where to Place the Display

Place your display on a flat sturdy surface. Ensure the operating site is free from excessive heat or moisture.

NOTE

The viewing angle of this display is limited. For your comfort, HP recommends that the display is positioned perpendicular to your line of sight. The top of the display screen should be at, or slightly below, your eye level.

Connecting the Cables

- 1 Before you connect any cables, refer to the safety instructions at the beginning of this manual and make sure your PC and display are switched off.
- 2 Remove the cable covers, starting with the top cover, followed by the bottom cover.

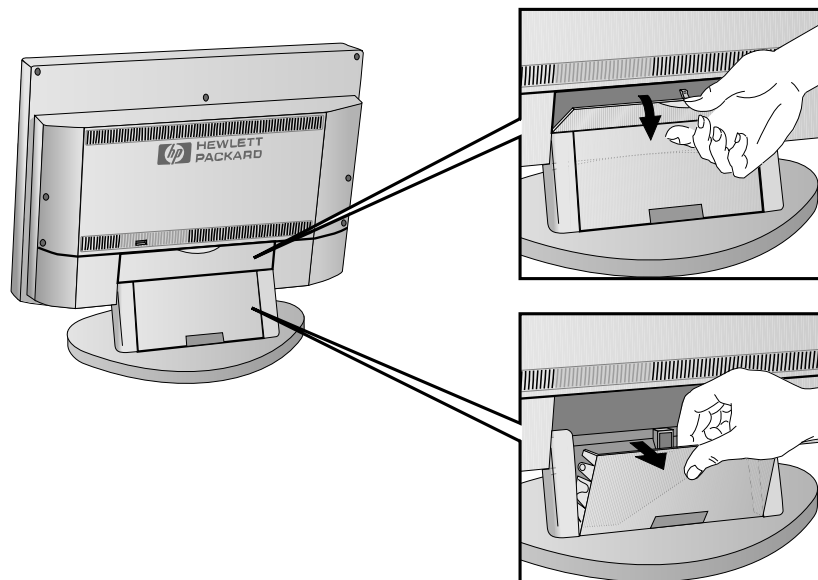

HP D5060A User's Guide

Setting Up Your Display

- 3 Connect the power cord to the AC adapter.
- 4 Insert the DC plug into the DC IN jack on the display.
- 5 Connect the video cable to the video input (it has a 15-pin plug) on the display. Tighten the thumbscrews on the plug.

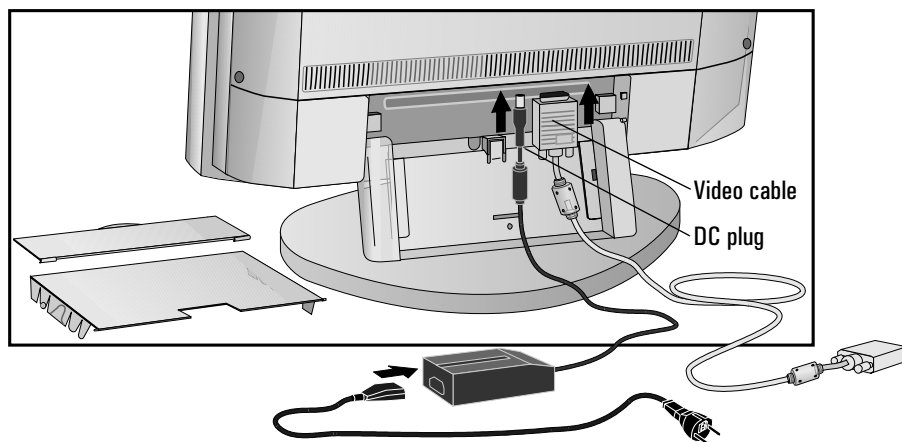

- 6 Replace the cable covers on the display.
- 7 Connect the video cable (it has a 15-pin plug) to the video outlet on your PC. Tighten the thumbscrews on the plug.
- 8 Plug the power cord into the power outlet.

Separating the Display from the Stand

The display is mounted on a tiltable stand. If desired, the display can be removed from this stand and mounted in another environment.

- 1 Remove the four screws (indicated below) from the rear of the display.

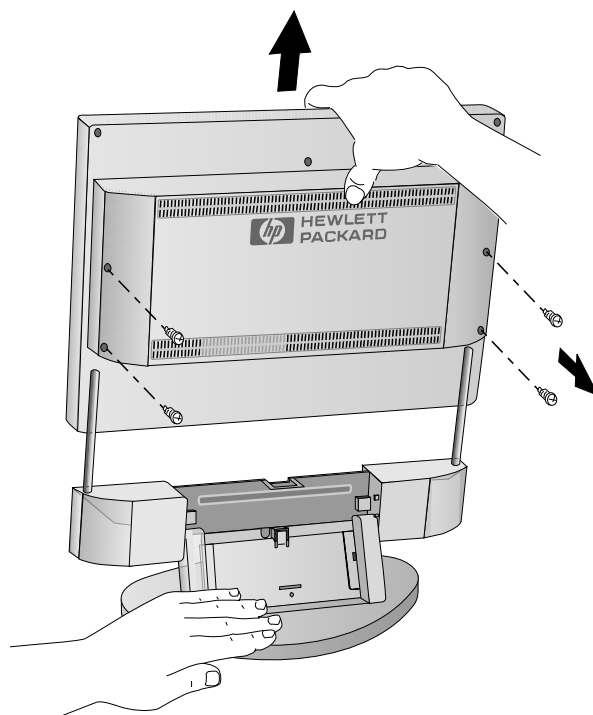

- 2 Carefully slide the display off the stand.

Securing the Display

The display can be secured to your desk, or any other fixed object, using a Kensington lock security cable. The cable can be locked to a slot located on the rear of the display.

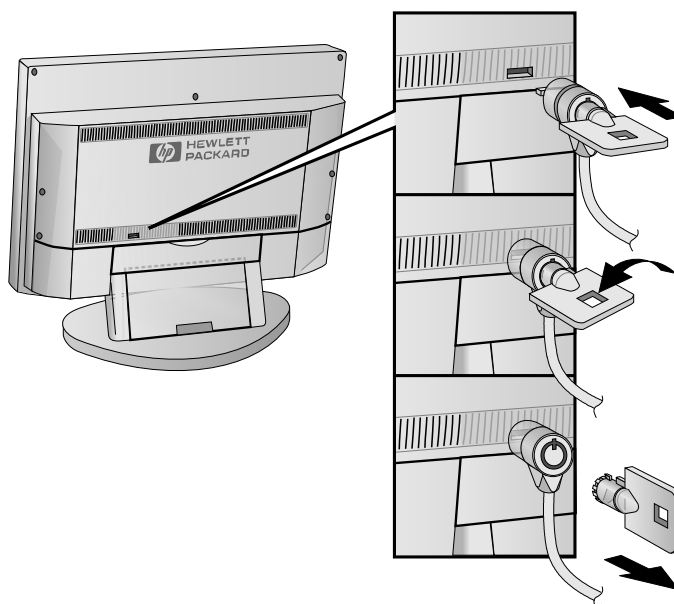

- 1 Insert the lock in the slot located on the rear of the display.
- 2 Turn the key to lock the cable to the display.
- 3 Remove the key and store it in a safe place.

NOTE

The Kensington lock security cable is not an HP accessory. It cannot be ordered from HP. Contact your reseller for more information.

Using the Display

IMPORTANT

You must adjust the display, using the display controls described below with the supplied HP Image Optimizer utility, to obtain an optimized image for your PC.

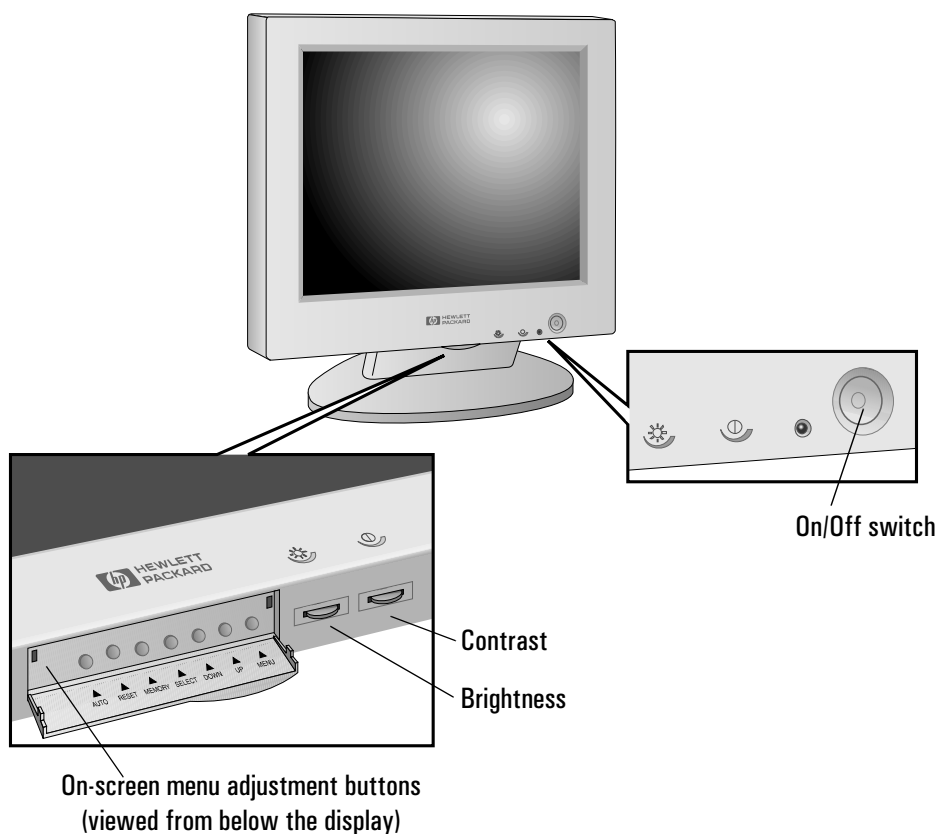

You can adjust the quality, position, size, and shape of the displayed image by using the on-screen menus. You can use the buttons below the front panel of the display to navigate through these menus.

The on/off switch and controls for image brightness and contrast are on the front of the display.



Adjusting the Display for the First Time

Each time you connect your display to a different PC, you will need to adjust it to optimize the quality of the image.

- 1 Open the door concealing the adjustment buttons below the front panel of the display.
- 2 Press the automatic  **AUTO** button. The display image will disappear for a few seconds while the display optimizes the image for your PC.
- 3 When the image appears, press the memory  **MEMORY** button to save the image adjustment in memory.

HP recommends that you allow a 10 minute warm-up delay, after switching on your display and PC, before optimizing the image quality.

Using the HP Image Optimizer utility

If the image adjustment obtained with the automatic  **AUTO** button is not satisfactory, use the HP Image Optimizer utility supplied with this display (on diskette) to help you adjust the display. You can use the utility to display test patterns on your display. These test patterns will help you configure your display with the on-screen display menus.

- 1 Insert the HP Image Optimizer utility in the flexible disk drive.
- 2 Select the appropriate directory on the diskette for your operating system:
 - **WIN311** (Windows 3.11), or
 - **WIN95NT** (Windows 95 and Windows NT).
- 3 Start the utility by double-clicking on the file named **D5060ADJ.EXE**.
- 4 Follow the instructions displayed by the utility to optimize the image for your display.

You can also install the HP Image Optimizer utility on your hard disk by copying the files from the diskette.

NOTE

The HP Image Optimizer utility can only be used with the Windows 3.11, Windows 95, and Windows NT operating systems.
This utility is not a driver and no change will be made on your hard disk.

Navigating Through the On-screen Menus

Here is how to navigate through the on-screen menus using the buttons under the front panel of the display:

To make this happen	Press this button ▲
Make the on-screen menu appear or disappear (the menu will disappear after one minute if no buttons are pressed)	△ AUTO △ RESET △ MEMORY △ SELECT ▽ DOWN △ UP ▲ MENU
Scroll up ▲ and down ▼ menu items	△ AUTO △ RESET △ MEMORY △ SELECT ▼ DOWN ▲ UP △ MENU
Select the highlighted menu item	△ AUTO △ RESET △ MEMORY ▲ SELECT ▽ DOWN △ UP △ MENU
Adjust the selected value	△ AUTO △ RESET △ MEMORY △ SELECT ▼ DOWN ▲ UP △ MENU
Exit the on-screen menu	△ AUTO △ RESET △ MEMORY △ SELECT ▽ DOWN △ UP ▲ MENU

Additional Options

The options described below can be accessed at anytime (without needing to access the on-screen menus).

To make this happen	Press this button ▲
Reset currently selected adjustments to factory settings	△ AUTO ▲ RESET △ MEMORY △ SELECT ▽ DOWN △ UP △ MENU
Store current mode adjustment in memory	△ AUTO △ RESET ▲ MEMORY △ SELECT ▽ DOWN △ UP △ MENU
Adjust the display automatically for your PC	▲ AUTO △ RESET △ MEMORY △ SELECT ▽ DOWN △ UP △ MENU

NOTE

HP recommends that you fine tune the image quality manually for your PC, using the HP Image Optimizer utility.

A Map of the On-Screen Menus

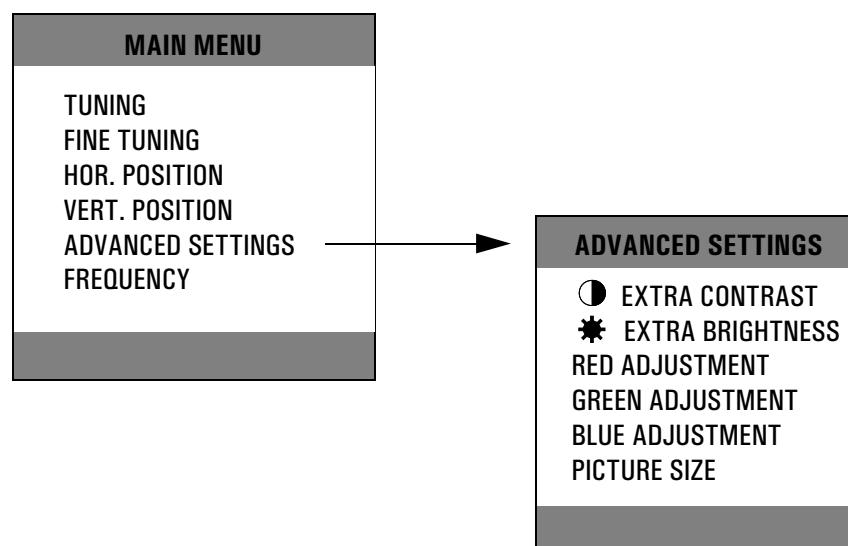

Adjustments made from the Main Menu

TUNING	To reduce flickering and blurring of displayed images. Use this adjustment with the HP Image Optimizer utility.
FINE TUNING	To reduce flickering and blurring of displayed images after making an adjustment with TUNING. Use this adjustment with the HP Image Optimizer utility.
HOR. POSITION	To adjust the horizontal position of the displayed image, select this menu item.
VERT. POSITION	To adjust the vertical position of the displayed image, select this menu item.
ADVANCED SETTINGS	To adjust the contrast, brightness, and color for the screen, select this menu item.
FREQUENCY	To display the frequency of the horizontal and vertical synchronizing signals from your PC, select this menu item.

Advanced Settings Menu

● EXTRA CONTRAST	To adjust the contrast (image white level), select this menu item. Contrast is the difference in brightness between the dark and light parts of the displayed image.
✱ EXTRA BRIGHTNESS	To adjust the overall picture brightness (image black level), select this menu item. Set the brightness so that the dark areas of the display remain black.
RED ADJUSTMENT	To adjust the amount of red present in the displayed image, use this menu item.
GREEN ADJUSTMENT	To adjust the amount of green present in the displayed image, use this menu item.
BLUE ADJUSTMENT	To adjust the amount of blue present in the displayed image, use this menu item.
PICTURE SIZE	To adjust the size of the image when the display mode is lower than 1024 × 768. SMALL shows the displayed image at a size matching that of the liquid crystal picture element. EXPANDED shows it at a size that fills the entire screen. (As the displayed image is enlarged, there will be some distortion of characters.)

Setting the Amount of Displayed Information

To set the amount of displayed information, change the *screen resolution* of your PC. The higher the screen resolution, the more information you can see on the screen. It is recommended that you use a resolution of 1024 × 768. The refresh rate can be set at 60 Hz, 70 Hz, or 75 Hz. The LCD technology does not cause any flicker at low refresh rates.

To find out which resolutions are supported by your display, refer to “Supported Video Modes” on page 16. To change the screen resolution, please refer to the manual that came with your PC or your operating system documentation, if necessary.

Your display has a Plug and Play capability (VESA DDC1/2B standard) that enables it to identify itself to suitably equipped HP Vectra PCs.

Minimizing Energy Consumption

If your PC supports VESA display power management (available on many HP Vectra PCs), you can minimize the power consumed by the display. There are two power saving modes:

- Standby mode¹ (uses less than 5 W). In this mode, the display's front panel indicator light is orange.
- Sleep mode² (uses less than 5 W). In this mode, the display's front panel indicator light is orange.

To set these power saving modes, refer to the manual that came with your PC. If your screen is not displaying an image, check the front panel indicator light first — your display may be in a power saving mode.

1. Standby mode is activated when vertical sync is cut by the video controller.

2. Sleep mode is activated when both vertical and horizontal sync are cut by the video controller.

Technical Specifications

LIQUID CRYSTAL DISPLAY	Size	14 inch
	Type	TFT liquid crystal
	Pixel Pitch	0.277 mm × 0.277 mm
INPUT SIGNAL	Video	0.66 Vp-p analog RGB
	Synchronization	Separated H/V (TTL level)
INTERFACE	Input Connectors	15-pin mini D-SUB
SCANNING FREQUENCY	Horizontal	31.5 to 61 kHz
	Vertical	50 to 90 Hz
MAX. RESOLUTION (H × V)	1024 × 768	
IMAGE SIZE	Standard size: 284(H) × 213(V) mm	
POWER SOURCE	AC ADAPTER Input: 100-240 V AC, 1.4-0.7 A, 50/60 Hz Output: 15 V DC, 4.0 A Power Consumption: 36 W in Operating mode, 5 W in Standby mode, 5 W in Sleep mode	
OPERATING ENVIRONMENT	Temperature	+ 5 °C to + 40 °C (operating) - 20 °C to + 60 °C (storage)
	Humidity	20% RH through 80% (without condensation)
DIMENSIONS	368(H) × 364(W) × 150(D)mm (including stand)	
WEIGHT	5 kg	

Supported Video Modes

Your display supports the video modes shown in the table below.

Screen Resolution	Image Refresh Rate	Video Solution
640 × 400	70 Hz	DOS
640 × 480	60 Hz	VGA
640 × 480	75 Hz	Ergonomic VGA
640 × 480	85 Hz	Ergonomic VGA
800 × 600	60 Hz	Ergonomic Super VGA
800 × 600	75 Hz	Ergonomic Super VGA
800 × 600	85 Hz	Ergonomic Super VGA
1024 × 768	60 Hz	Ergonomic Ultra VGA 1024
1024 × 768	70 Hz	Ergonomic Ultra VGA 1024
1024 × 768	75 Hz	Ergonomic Ultra VGA 1024

CAUTION

Selecting a screen resolution/vertical frequency combination higher than 1024 × 768 at 75 Hz can damage your display.

Care and Cleaning

Do not let liquid get on or into the display. Do not store or use the display in locations exposed to heat, direct sunlight, or extreme cold. Do not store or use the display in locations exposed to high humidity or in a dusty environment. Do not press sharp or pointed objects against the display. Avoid touching or pressing the liquid crystal display.

To maximize the lifetime of this product and prevent damage to the liquid crystal display (due to leaving the same image on the screen for a long time), it is recommended that you:

- Use the display power management system (on HP Vectra PCs) or a screen saver program.
- Avoid setting contrast and brightness to their maximum levels for prolonged periods.
- If you do not have a power management system or a screen saver program, switch the display off or reduce the brightness and contrast to minimum levels when the display is not in use.

Your display has an anti-glare, anti-static screen coating. To clean the screen:

- 1 Switch the display off and remove the power plug (pull the plug, not the cable).
- 2 Soak a soft gauze cloth with isopropyl alcohol or ethyl alcohol and gently wipe the surface of the display. Avoid dusting it or wiping it with a cloth dampened with water.
- 3 Dry with a clean, soft cotton cloth.

Do not use cleaning solutions containing fluoride, acids, or alkalis. Do not use ketone substances such as acetone or solvents such as xylene or toluene to clean the display.

Hardware Warranty

This is your HP Display Hardware Warranty Statement. Warranty terms may be different in your country. If so, your Authorized HP Dealer or Hewlett-Packard Sales and Service Office can give you details.

Limited Display Hardware Warranty

Model	Warranty Period	Service provided
Model D5060A	1 year	On-site service

Hewlett-Packard (HP) warrants this display hardware product against defects in materials and workmanship for the applicable warranty period stated above, commencing from the date of purchase by you, the original end-user customer. If you return this display hardware product with a defect as defined above, during the warranty period, to an HP-authorized reseller or service center, HP will either, at its option, repair or replace the defective product with a new or equivalent-to-new unit of the same or equivalent model. Should HP be unable to repair or replace the product within a reasonable amount of time, your alternate exclusive remedy shall be a refund of the purchase price upon return of the product.

If you purchased this display hardware product for use with an HP Vectra personal computer, please refer to the terms and conditions of the HP Hardware Warranty statement provided with your HP Vectra personal computer, including limitations, your responsibilities and method for obtaining warranty service.

Limitation of Warranty

The above warranty shall not apply to defects resulting from: misuse; unauthorized modification; operation or storage outside the environmental specifications for this display product; in-transit damage; improper maintenance; or defects resulting from use of non-HP software, accessories, media, supplies, consumables, or such items not designed for use with this product.

HP MAKES NO OTHER EXPRESS WARRANTY, WHETHER WRITTEN OR ORAL, WITH RESPECT TO THIS PRODUCT. ANY IMPLIED WARRANTY OF MERCHANTABILITY OR FITNESS FOR A PARTICULAR PURPOSE IS LIMITED TO THE DURATION OF THE EXPRESS WARRANTY SET FORTH ABOVE.

Some states or provinces do not allow limitations on warranty, so the above limitation or exclusion may not apply to you. This warranty gives you specific legal rights, and you may also have other rights which vary from state to state, or province to province.

Limitation of Liability and Remedies

THE REMEDIES PROVIDED ABOVE ARE YOUR SOLE AND EXCLUSIVE REMEDIES. IN NO EVENT SHALL HP BE LIABLE FOR ANY OTHER DIRECT, INDIRECT, SPECIAL, INCIDENTAL, OR CONSEQUENTIAL DAMAGES, WHETHER BASED ON WARRANTY, CONTRACT, TORT, OR ANY OTHER LEGAL THEORY.

The foregoing limitation of liability shall not apply in the event that any HP product sold hereunder is determined by a court of competent jurisdiction to be defective and to have directly caused bodily injury, death, or property damage; provided, that in no event shall HP's liability for property damage exceed the greater of \$50,000 or the purchase price of the specific product that caused such damage.

Some states or provinces do not allow the exclusion or limitation of incidental or consequential damages, so the above limitation or exclusion may not apply to you.

LCD Display Quality and Pixel Policy

Your Hewlett-Packard TFT display uses high precision technology, manufactured according to HP standards, to guarantee trouble-free personal computing.

Nevertheless, your display may have cosmetic imperfections which could appear as small bright or dark spots. This is common to all TFT displays used in products supplied by all vendors and is not specific to the HP D5060A display.

Please refer to the HP electronic services for more and detailed information on the pixel policy for the D5060A.

HP expects that, over time, the industry will continue to improve their ability to produce displays with fewer cosmetic imperfections and will adjust the HP guidelines as improvements are made.

Regulatory Information

DECLARATION OF CONFORMITY
according to ISO/IEC Guide 22 and EN 45014

Manufacturer's Name: HEWLETT-PACKARD

Manufacturer's Address: 5, Avenue Raymond Chanas
38320 Eybens, FRANCE

declares, that the product:

Product Name: HP 1024 14-inch Liquid Crystal Color Display
Model Number: D5060A

conforms to the following Product Specifications:

<u>SAFETY</u>	International: IEC 950:1991 + A1 + A2 + A3 European: EN 60950:1992 + A1 + A2
<u>EMC</u>	CISPR 22:1993 / EN 55022:1994 - Class B EN 50082-1:1992 IEC 801-2:1992 / prEN 55024-2:1992 - 4kV CD, 8 kV AD IEC 801-3:1984 - 3V/m IEC 801-4:1988 / prEN 55024-4:1992 - 1 kV Power lines IEC 555-2:1982 + A1:1985 / EN 60555-2:1987 IEC 1000-3-3:1994 / EN 61000-3-3:1995

Supplementary information: the product herewith complies with the requirements of the Low Voltage Directive 73/23/EEC and the EMC Directive 89/336/EEC amended by the Directive 93/68/EEC, and carries the CE-marking accordingly.



Jean Marc JULIA
Quality Manager

Grenoble, March 1997

Notice for the USA: FCC Statement

Federal Communications Commission (FCC) Radio Frequency Interference Statement (USA Only)

This equipment has been tested and found to comply with the limits for a Class B digital device, pursuant to Part 15 of the FCC Rules. These limits are designed to provide reasonable protections against harmful interference in a residential installation. This equipment generates, uses and can radiate radio frequency energy and, if not installed and used in accordance with the instructions, may cause harmful interference to radio communications. However, there is no guarantee that interference will not occur in a particular installation. If this equipment does cause harmful interference to radio or television reception, which can be determined by turning the equipment off and on, the user is encouraged to try one of more of the following measures:

- Relocate the radio or television antenna.
- Move the computer away from the radio or television.
- Plug the computer into a different electrical outlet, so that the computer and the radio or television are on separate electrical circuits.
- Make sure that all your peripheral devices are also FCC Class B certified.
- Make sure you use only shielded cables to connect peripheral devices to your computer.
- Consult your computer dealer, Hewlett-Packard, or an experienced radio/television technician for help.

WARNING

Hewlett-Packard's system certification tests were conducted with HP-supported peripheral devices and HP shielded cables, such as those you received with your system. Cables used with this computer must be properly shielded to comply with the requirements of the FCC.

Changes or modifications not expressly approved by Hewlett-Packard could void the user's authority to operate the equipment.

General Notice

The HP D5060A 1024 14-inch Liquid Crystal Color Display has been tested according to MPR 1990:8 for Emission properties and meets the guidelines as given by MPR 1990:10 (2.01 - 2.04). It also complies with TCO-92 specifications for measurement of magnetic fields, power-down and safety.

Notice for Japan

この装置は、情報処理装置等電波障害自主規制協議会（VCCI）の基準に基づく第二種情報技術装置です。この装置は、家庭環境で使用することを目的としていますが、この装置がラジオやテレビジョン受信機に近接して使用されると、受信障害を引き起こすことがあります。
取扱説明書に従って正しい取り扱いをして下さい。

Notice for Canada

This Class "B" digital apparatus meets all requirements of the Canadian Interference-Causing Equipment Regulations.

Cet appareil numérique de la Classe B respecte toutes les exigences du règlement sur le matériel brouilleur du Canada.

Environmental Information

HP has a strong commitment toward the environment. Your HP display has been designed to respect the environment as much as possible.

HP can also take back your old display for recycling when it reaches the end of its useful life.

In fact, HP has a product take-back program in several countries. The collected equipment is sent to of HP's recycling facilities in Europe or the USA. As many parts as possible are reused. The remainder is recycled. Special care is taken for batteries and other potentially toxic substances, which are reduced to non-harmful components through a special chemical process. If you require more details about HP's product take-back program, contact your dealer or your nearest HP Sales Office.

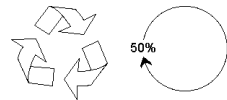

Paper not bleached with chlorine
Manual Part Number D5060-90001
Printed in Japan - 3/97

